

# STRIP LED FLEX

204LEDs/m - 17,5W/m - 24Vdc



## INFORMAZIONI PRODOTTO:

PRODUCT INFORMATIONS:

Codice d'acquisto: **05397**

Purchase code: **SL00551**

Grado IP: **IP65**

Alimentazione: **24Vdc**

Potenza: **17,5W/m**

Rialimentazione: **Fino a - Up to 5m**

Alimentatore: **Driver SELV 24Vdc (non incluso / not included)**

Dimmerabile: **Si (dimmer non incluso) - Yes (dimmer not included)**

Sorgente luminosa: **LED SMD 2835**

CCT/ Colore: **2700K**

Flusso: **1975lm/m**

Fascio: **120°**

CRI: **>90**

Tolleranza cromatica: **3 SDCM**

Vita utile: **L70B50@60000h**

Fissaggio: **Adesivo + Clip di fissaggio (non include) - Adhesive + Fixing clips (not included)**

Temperatura operativa: **-10°C (min) - +30°C (max)**

Norme: **EN62031:2018**  
(LED modules for general lighting - Safety specification)

**IEC TR 62778:2014**  
(Application of IEC 62471 for the assessment of blue light hazard to light source and luminaires)

**EN61547:2009**  
(EMC immunity requirements)

**EN55015:2019+A11:2020**  
(Limits and methods of measurement of radio disturbance characteristics of electrical lighting)

Garanzia: **2 anni / 2 years**

Classe energetica: **Prodotto contenente una sorgente luminosa di classe <F>**  
Energetic class: **Product containing an energy class <F> light source**

Unità: mm  
Unit: mm

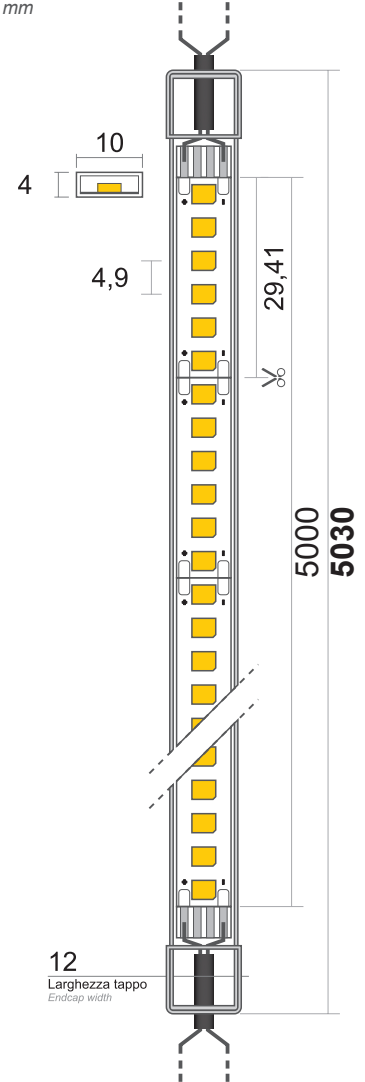

Uscita cavo / Cable output: IN/OUT  
Lunghezza cavi / Cables length: 200mm

## ACCESSORI:

ACCESSORIES:

Codice: **Descrizione:**  
Code: **Description:**

**05180** Clip di fissaggio  
Fixing clip

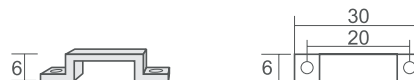

**05187** Tappo chiuso  
Closed endcap

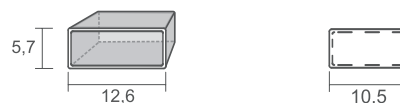

**05188** Tappo aperto  
Grommet endcap

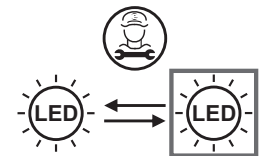
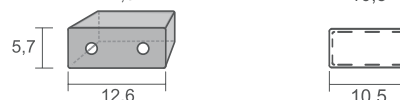

Tolleranza di potenza ± 5% - Tolleranza al flusso luminoso ± 5% - Incertezza di misura ± 10% - Ta: 25°C Power tolerance ± 5% - Luminous flux tolerance ± 5% - Measurement uncertainty ± 10% - Ta: 25°C